

TOP PLATE CONSTRUCTED OF 5/8" GRADE 50 A572 STEEL

SIDE PLATES CONSTRUCTED OF 3/8" A36 STEEL

TOTAL BLOCK WEIGHT RANGES FROM 3500 TO 3700 LBS

SIDE 20.5" TRUSS ATTACHMENT FOR OUTRIGGER

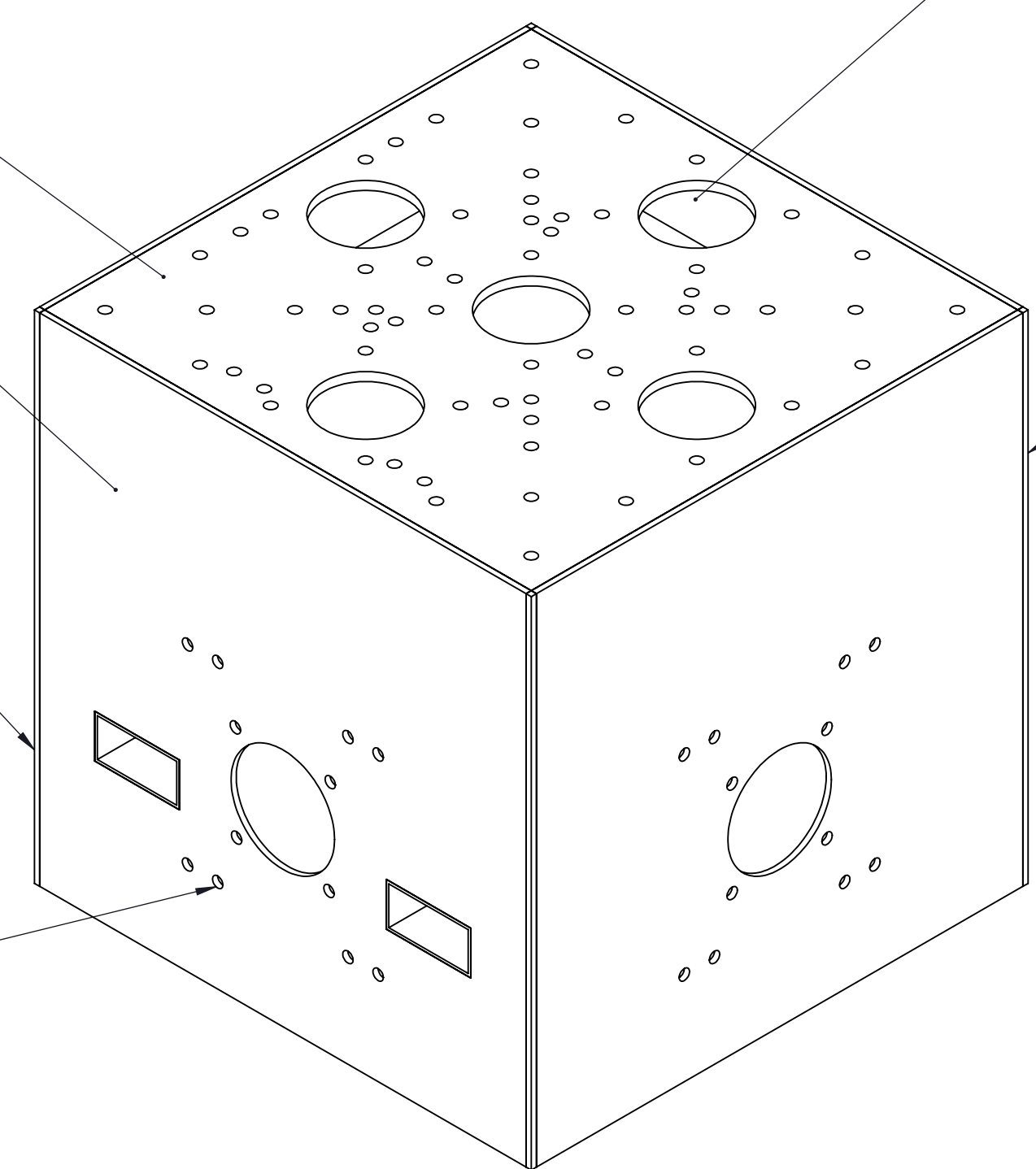

BLOCK IS FILLED 95% WITH CONCRETE ENCASED IN REBAR AND FRAMING, (PER ENGINEER) WES BROWN HOPPER ENGINEERING

ALL CONNECTION POINTS ARE WELDED 100%

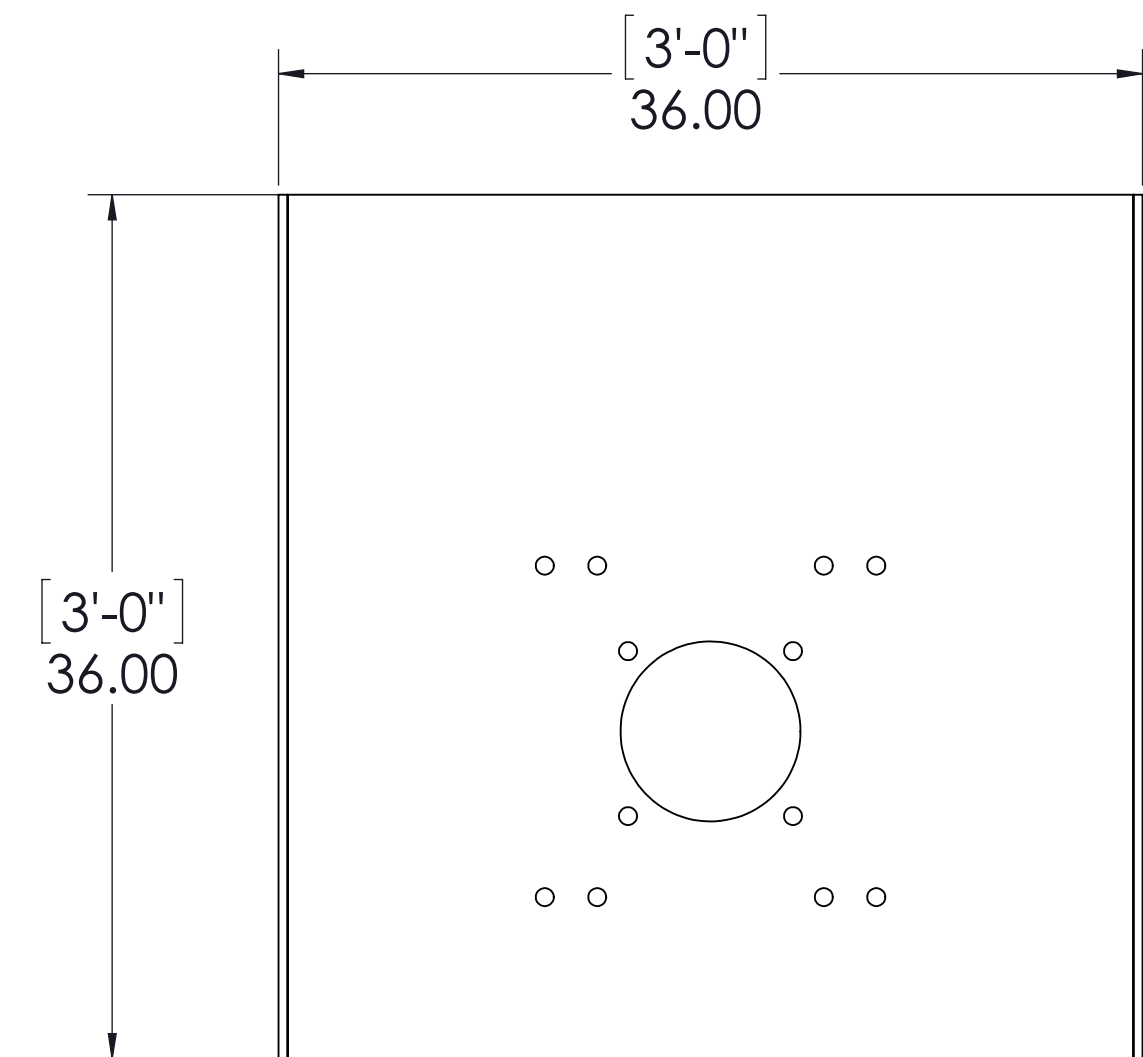
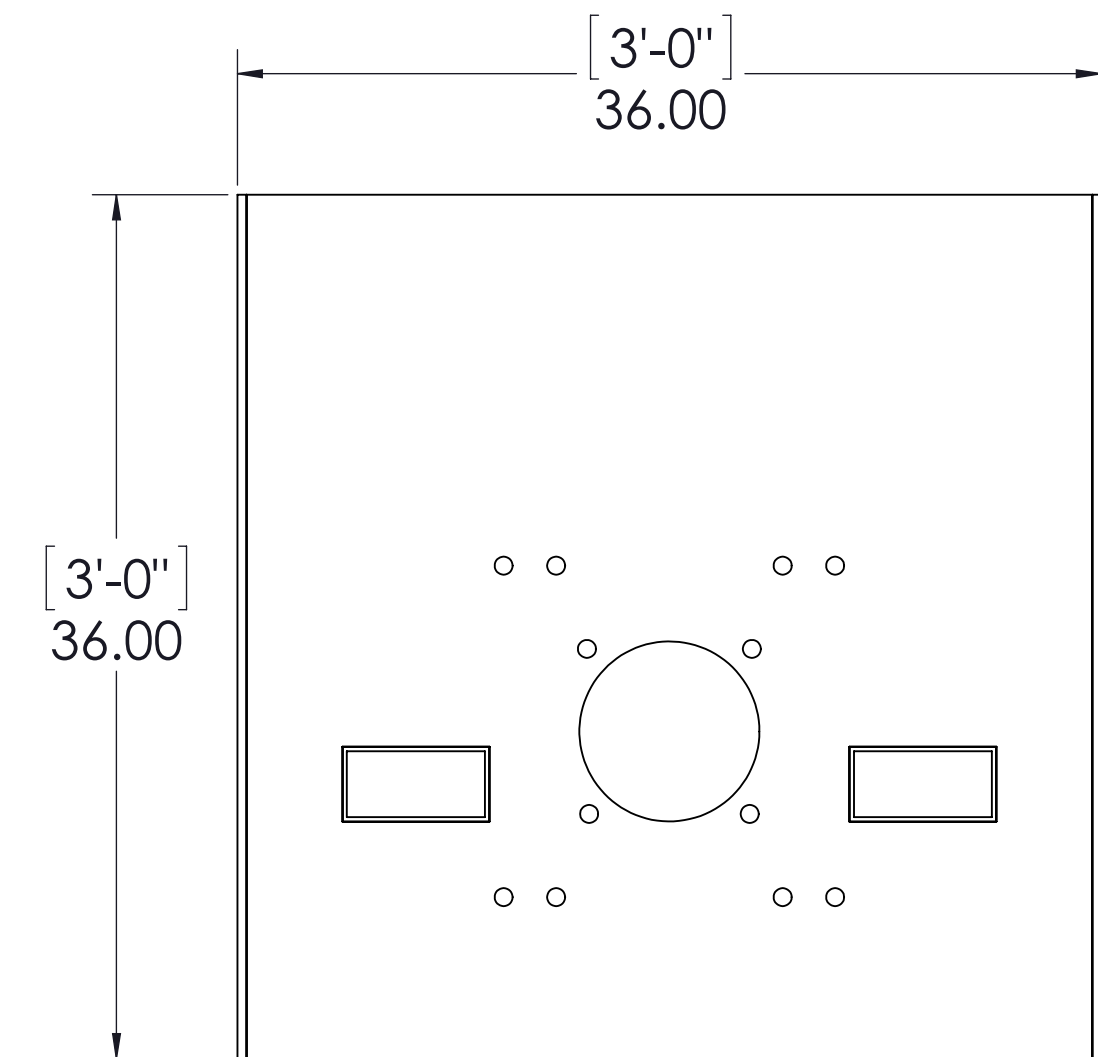

NOTES: UNLESS OTHERWISE SPECIFIED

PROJECT NAME: G-BLOCK ASSY	DATE: 03/09/2014
DRAWING TITLE: G-BLOCK ASSY	REVISION: V2
PROJECT NUMBER:	SCALE: 1 TO 8 ON 11 X 17 PAGE

GALLAGHER STAGING & PRODUCTIONS
15701 HERON AVE
LA MIRADA, CA 90638

